

Dot-On XS



Functional Specifications

RF air protocol	EPC Class 1 Gen 2; ISO18000-6C
Operating frequency	UHF 902-928 MHz (US); 866-868 MHz (EU)
IC type	Alien Higgs-3
Memory configuration	96-EPC bits; 512-bit user memory
Functionality	Read / write (user programmed)
Memory – expected read / write cycles	100,000 cycles at 77°F (25°C)
Data retention	10 years
Read rate	400 tags per second for 96-EPC bit number
Warranty (limited)	1 year

Performance Characteristics

Read range on metal, 4W EIRP (2W ERP)*	Up to 5 ft (1.5 m)
Polarization	Linear
Performance quality	100% tested

*Actual read range may vary based upon specific application case and antenna power

Physical Specifications

Material	Ceramic
Mounting system	Epoxy
Color	Black

Environmental and Industry Compliance

FDA	Designed to comply with FDA guidelines
RoHS	EU Directive 2002/95/EC

Radiation Pattern

On metal

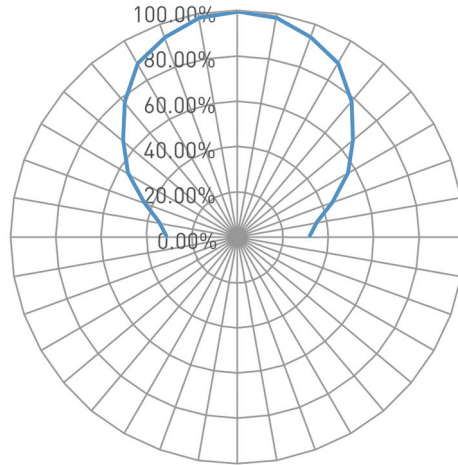

Operational and Environmental Specifications

Operational temperature	
Cold	-40°F (-40°C)
Dry heat	+185°F (+85°C)
Application temperature	
Cold	-40°F (-40°C)
Dry heat	+302°F (+150°C)
Humidity	
Operational humidity	5%-95% non-condensing
Storage humidity	5%-95% non-condensing
Shock (drop)	3 ft (1 m) to concrete/granite up to 200 cycles
IP classification	IP68

Product Dimensions and Weight

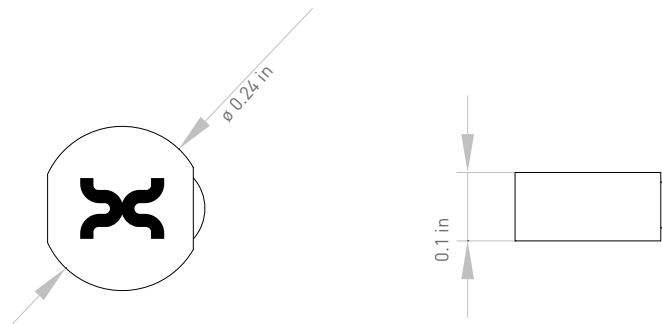

Dimensions	ø 0.24 x 0.1 in (ø 6 x 2.5 mm)
Weight	0.02 oz (0.5 g)

Dot-iN XS



Functional Specifications

RF air protocol	EPC Class 1 Gen 2; ISO18000-6C
Operating frequency	UHF 902-928 MHz (US); 866-868 MHz (EU)
IC type	Alien Higgs-3
Memory configuration	96-EPC bits; 512-bit user memory
Functionality	Read / write (user programmed)
Memory – expected read / write cycles	100,000 cycles at 77°F (25°C)
Data retention	10 years
Read rate	400 tags per second for 96-EPC bit number
Warranty (limited)	1 year

Performance Characteristics

Read range embedded in metal, 4W EIRP (2W ERP)*	Up to 3 ft (1 m)
Polarization	Linear
Performance quality	100% tested

*Actual read range may vary based upon specific application case and antenna power

Physical Specifications

Material	Ceramic
Mounting system	Epoxy
Color	White

Environmental and Industry Compliance

FDA	Designed to comply with FDA guidelines
RoHS	EU Directive 2002/95/EC

Radiation Pattern

In metal

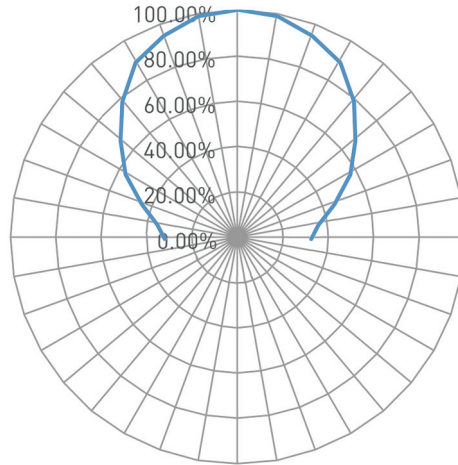

Operational and Environmental Specifications

Operational temperature	
Cold	-40°F (-40°C)
Dry heat	+185°F (+85°C)
Application temperature	
Cold	-40°F (-40°C)
Dry heat	+302°F (+150°C)
Humidity	
Operational humidity	5%-95% non-condensing
Storage humidity	5%-95% non-condensing
Shock (drop)	3 ft (1 m) to concrete/granite up to 200 cycles
IP classification	IP68

Product Dimensions and Weight

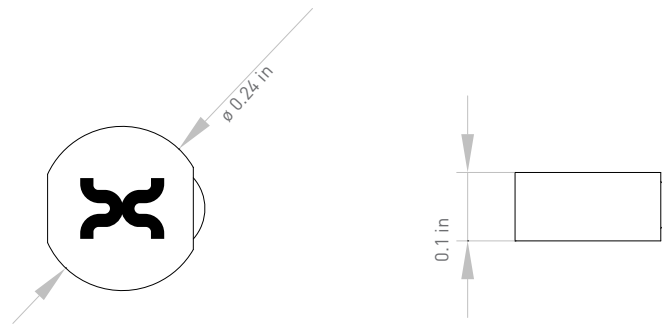

Dimensions	ø 0.24 x 0.1 in (ø 6 x 2.5 mm)
Weight	0.02 oz (0.5 g)